



PERFORM 45 SE

Technology for life's new rhythm

© 2025 GN Hearing A/S. All rights reserved. Jabra® is a trademark of GN Hearing A/S. The Bluetooth® word mark and logos are registered trademarks owned by the Bluetooth SIG, Inc. and any use of such marks by GN Hearing A/S is under license.

Made in Vietnam
MODEL: OTE985



Declaration of Conformity can be found on
www.jabra.com/doc

1. Welcome.....	5
2. Overview.....	6
2.1 Included accessories	
2.2 Optional accessories	
3. How to wear.....	8
3.1 Selecting an EarGel	
3.2 How to get the perfect fit	
4. How to charge.....	10
5. How to connect.....	12
5.1 Power on	
5.2 Power off	
5.3 Pair with your smartphone	
5.4 Connect to your smartphone using NFC	
6. How to use	15
6.1 Calls	
6.2 The Customizable button	
6.3 Multiple call handling	
6.4 Voice controls	
6.5 Multipoint mode	
6.6 Update firmware	
6.7 Reset headset	
6.8 Clear the list of paired devices	
7. Jabra Direct app.....	22

8. Support 23

8.1 FAQ

8.2 How to care for the headset

8.3 How to clean the headset

1. Welcome

Thank you for using the Jabra Perform 45 SE.
We hope you will enjoy it!

Jabra Perform 45 SE features:

- **Small, lightweight, and discreet**, so you always look approachable to customers
- **93% noise-cancelling microphones** and crystal-clear sound keeps communication smooth
- **Push-to-Talk** lets you instantly communicate with colleagues
- **Easy to set up** and intuitive to use, with a durable, simple-to-sanitize design
- **Up to 27 hours Push-to-Talk usage**, and up to 100m / 300ft wireless range

2. Overview

Multi-function button

Power on (*press*) / off (*long press*)

Pairing (*double press*)

Voice assistant
(*hold and release*)

Answer/end call (*press*)

Reject call (*hold*)

Status LED

Volume up

Volume down

USB-C charging port

Customizable button

Push-to-Talk

Check battery level

Voice control (*standby*)
or Mute (*in a call*)

Microphones

SECURITY NOTE:

Microphones can potentially be used to record private conversations.

2.1 Included accessories

USB cable

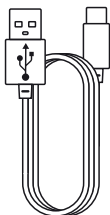

EarGels



Small



Medium
(*pre-mounted on
the headset*)



Large

2.2 Optional accessories

Optional accessories are available at jabra.com/accessories.

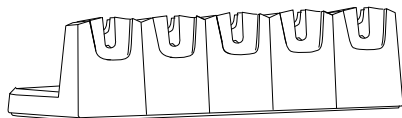

Jabra Perform Charging Stand, 5-Bay

3. How to wear

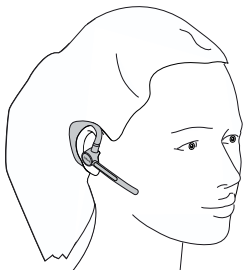

The headset can be worn on the left or right ear.

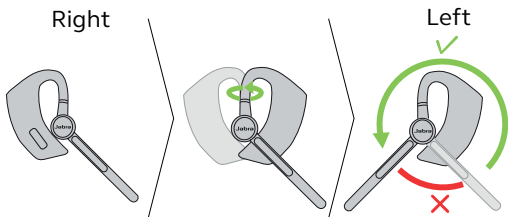

To wear the headset on the other ear, rotate the microphone horizontally to the other side. Then move the microphone up and over and point it towards your mouth.

SECURITY NOTE:

Microphones can potentially be used to record private conversations.

3.1 Selecting an EarGel

It is important to wear the headset with the most comfortable EarGel size for your ears. This will ensure the best audio experience.



Small



Medium



Large

3.2 How to get the perfect fit

For the best audio quality and comfort, the EarGel should fit firmly in your ear, but should not be squeezed into your ear canal.

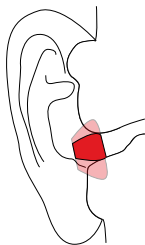
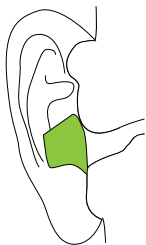

4. How to charge

To charge the headset, connect the USB-C charging cable to the headset's charging port. It is recommended to charge the headset using the supplied charging cable. It takes up to 120 minutes to fully charge the battery.

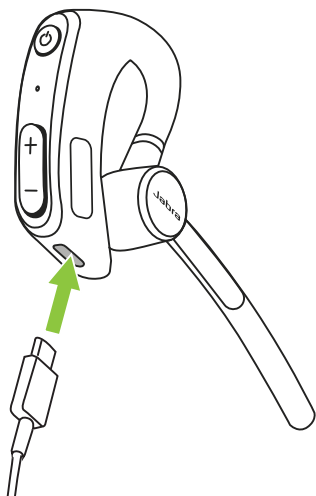

While charging, the LED indicator shows the charging status. Yellow indicates the headset is charging. Green indicates the headset is fully charged.

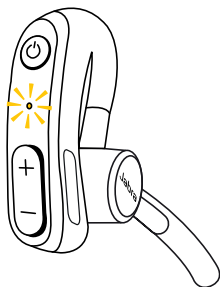

Charging

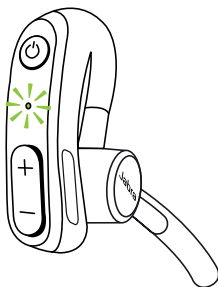

Fully charged

5. How to connect

5.1 Power on

Press and hold the **Multi-function** button for 1 second until the LED flashes blue and you hear “On”.

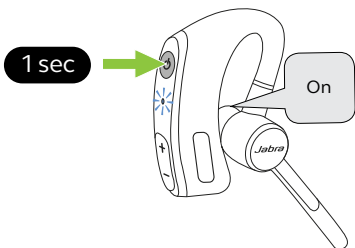

5.2 Power off

Press and hold the **Multi-function** button for 6 seconds until the LED flashes red and you hear “Off”.

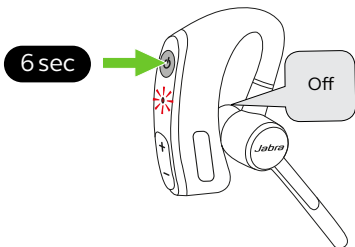

5.3 Pair with your smartphone

1. Ensure the headset is powered on.
2. Double-press the **Multi-function** button until you hear "Pairing" and the LED flashes red and blue. The headset is now ready to pair.
3. Go to the Bluetooth menu on your smartphone and select the **Jabra Perform 45 SE** from the list of available devices.
4. You will hear "Connected" when the headset and your smartphone are successfully connected.

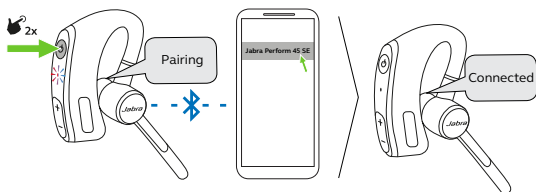

SECURITY NOTE:

The headset uses a secure Bluetooth connection with an encryption key size of 128 bits. If your Bluetooth device does not support secure connections, it will not be able to pair or connect to the headset.

5.4 Connect to your smartphone using NFC

1. Ensure the headset is powered on, and that NFC is enabled on your smartphone.
2. Place the NFC zone of your smartphone against the NFC zone of the headset until your smartphone confirms the connection.

Please note that not all phones support NFC pairing.

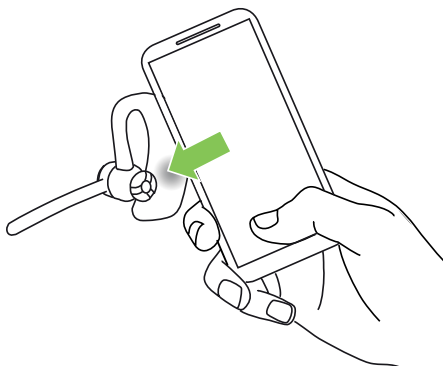

SECURITY NOTE:

NFC can potentially be used to detect the presence of a user.

6. How to use

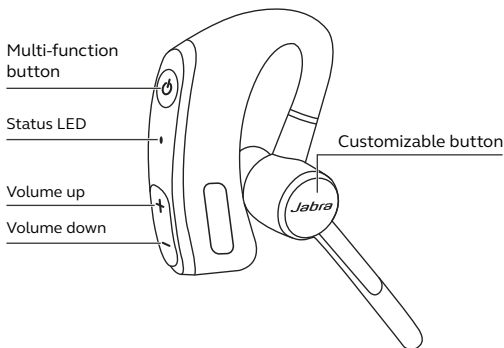

6.1 Calls

	Answer call	Press the Multi-function button, say "Answer" or swivel the microphone down
	End call	Press the Multi-function button
	Reject call	Press and hold the Multi-function button or say "Ignore"
	Activate Voice Assistant (i.e. Siri, Google Assistant)	Hold and release the Multi-function button when not on a call



Adjust volume

Press the **Volume up** or **Volume down** button, when listening to music or on a call.



Redial last number

Press and hold the **Multi-function** button and **Volume down** button

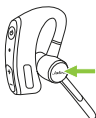

Mute/un-mute microphone

Press the **Customizable button** when on a call.

A mute reminder tone will play approx. every 45 seconds to notify that the headset is muted.



Mute/unmute microphone during a call

Swivel the microphone up during a call to mute the microphone. Swivel the microphone down to unmute.

A mute reminder tone will play approx. every 45 seconds to notify that the headset is muted.

SECURITY NOTE:

Microphone boom arm sensors can potentially be used to detect the presence of a user.

6.2 The Customizable button

By default, the Customizable button is set to voice control in standby and mute microphone while you are on a call. However, the button can be configured for other functions, such as Push-to-Talk, access second paired mobile device, check the battery level, or assign a second Multi-function button for the paired mobile devices.

To reconfigure the Customizable button, download and use [Jabra Direct](#).

6.3 Multiple call handling

The headset can accept and handle multiple calls at the same time.

Multiple call handling



End current call and answer incoming call

Press the **Multi-function** button to end the current call. Then press the **Multi-function** button to answer the incoming call

Put current call on hold and answer incoming call

Press the **Multi-function** button twice

Reject incoming call when on a call

Press and hold (2 sec) the **Multi-function** button

6.4 Voice controls

The headset recognizes English voice commands, enabling call handle without touching the headset.

Press the customizable button (when not on a call) to activate the voice controls.

List of voice controls:

- **“Answer”** – answers an incoming call
- **“Ignore”** – rejects an incoming call and sends it to voicemail (if available)
- **“List commands”** – announces a list of available commands
- **“Pairing”** – puts the headset into pairing mode
- **“Connection status”** – verifies that the headset is connected to a device
- **“Battery status”** – announces battery level for the headset
- **“Cancel”** – cancels Voice control

6.5 Multipoint mode

The headset can pair with 8 smartphones and connect to 2 at once.

To connect to 2 smartphones, use the normal pairing process separately for each smartphone (refer to section 5).

The Jabra Perform 45 SE will monitor both smartphones and enable you to answer a call on either one using the headset.

If you are on a call and the other smartphone receives a call, you will hear a notification in the headset.

The voice assistant will be activated on the last connected smartphone.

6.6 Update firmware

It is recommended to update your Jabra Perform 45 SE to the latest firmware available before first use.

Firmware updates improve performance or add new functionality to Jabra devices. Update your Jabra Perform 45 SE using [Jabra Direct](#).

6.7 Reset headset

The headset settings will be reset back to default and the list of paired devices will be cleared.

1. Ensure the headset is powered on.
2. Press and hold (5 sec) both the **Customizable button** and **Volume down** button until you hear "Resetting product". The LED will rapidly flash pink. The headset goes directly into pairing mode.

You will need to re-pair the headset with your smartphone.

6.8 Clear the list of paired devices

1. Ensure the headset is powered on.
2. Press and hold (6 sec) both the **Volume up** and **Volume down** buttons. The LED will rapidly flash blue. The headset goes directly into pairing mode.

You will need to re-pair the headset with your smartphone.

7. Jabra Direct app

Jabra Direct is a desktop application designed to support, manage and enable optimal functionality for Jabra devices.

Download the latest free version from jabra.com/direct

8. Support

8.1 FAQ

View the FAQs at <https://www.jabra.com/help/perform-45-se>

8.2 How to care for the headset

- To prevent the depletion of the battery lifetime or capacity, avoid storing the headset in hot or cold environments, such as a closed vehicle in summer or in winter conditions.
- For daily sanitization, 70% isopropyl alcohol wipes are recommended.
- When exposed to water, allow the headset sufficient time to dry. It may take up to one hour for the headset to dry thoroughly.
- Do not store the headset for extended periods of time without recharging it (max. three months).

8.3 How to clean the headset

1. Apply normal dish soap and water to a cloth, making sure to wring out any excess liquid so the cloth is not dripping wet. Use soap and water only; do not use strong cleaning agents.
2. Gently wipe the headset with the wet cloth, making sure the headset is clean with no layer of suds on the surface.
3. Let the headset rest for at least one minute.
4. Wipe the headset clean with a cloth dampened with water only.
5. Allow the product to dry.